

# EDGETilt3 Recessed

Direct | Standard Lengths

Project Name \_\_\_\_\_

Fixture Type \_\_\_\_\_

# XICO®



## LIGHTING CONFIGURATIONS

Direct

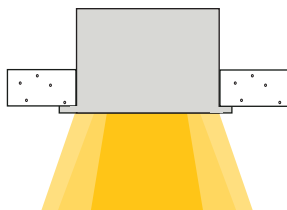

## DESCRIPTION

### 3" Edge-Lit Assymetric Recessed Linear LED Light

EDGETilt3 is an innovative low-profile 3" wide LED luminaire designed to be used in applications requiring recessed drywall or gypsum mounting. It is also available for mounting into T-Bar ceiling installs and is especially suited to low or zero plenum. EDGETilt3 provides best-in-class efficiency and beam control options. EDGETilt3 incorporates an engineered LED light engine with fully customizable choices for lumen output, CCT and CRI.

## FEATURES & BENEFITS

### Designed for PERimeter, Wall or Ceiling Washing

Up to 1,250 lm/ft, 135 lm/W efficacy with choice of mounting for asymmetric, symmetric or lambertian beams

### Wide Range of LED Selections

Static, Tunable White, and Dim-to-Warm

### Designed with Options

Wide choice of SmartOptic® lenses, beam distributions, 80/90/95+ CRI, 2700K to 6500K CCT, and 0-10V, DALI, DMX, and TRIAC dimming

### Patented Innovations

Fusion® Optix Inside with unique SmartBeam® capabilities

### Proprietary Optical Components

Provides excellent light distribution and high-transmission

### Committed to Sustainability

Declare Listed and Red Free List materials

### Compliance

UL Listed, Dry and Damp Locations

### 5-Year Warranty

Standard 5-year warranty, 50,000 hours

**Declare**



**bios**



Designed & Built in  
**BOSTON**

## FIXTURE ORDERING

Project Name \_\_\_\_\_

Fixture Type \_\_\_\_\_

### 1) FIXTURE DESIGN

PRODUCT	FIXTURE LENGTH	FINISH	END CAP
<b>ETI3-R</b> 3" Edge-Lit Asymmetric Recessed Linear LED Light	<b>2</b> - 2 ft <b>4</b> - 4 ft <b>6</b> - 6 ft <b>8</b> - 8 ft <b>X_</b> - Specify Ft', In"  Custom fixtures are available in 3" increments beyond standard lengths.	<b>Powder Coated</b> <b>PMW</b> - Matte White <b>PMB</b> - Matte Black <b>PMG</b> - Matte Gray <b>PRAL_</b> - Specify RAL #  <b>Anodized</b> <b>ACL</b> - Clear Anodized <b>ACU_</b> - Custom Anodized #	<b>E1</b> - Flanged End Cap <b>E2</b> - Flange-Less End Cap

### 2) LED LIGHT ENGINE

CRI	CCT	DIRECT BEAM PATTERN	DIRECT OUTPUT
<b>80</b> - Std. 80 CRI <b>90</b> - Std. 90 CRI <b>95</b> - High-Def. 95 CRI <b>SUN</b> - Full SunLike	<b>27</b> - 2700K <b>30</b> - 3000K <b>35</b> - 3500K <b>40</b> - 4000K <b>XD</b> - Dim-to-Warm <b>XT</b> - Tunable <b>X_</b> - Specify CCT  Specify Dim-to-Warm and Tunable between 2700K-6500K.	<b>DLAM</b> - Lambertian <b>D5545</b> - Asym 55°at 45° Tilt <b>X_</b> - Specify Beam¹	<b>35</b> - 350 lm/ft <b>50</b> - 500 lm/ft <b>75</b> - 750 lm/ft <b>100</b> - 1,000 lm/ft <b>X_</b> - Specify lm/ft

### 3) FIXTURE POWER & CONTROLS

LINE VOLTAGE (DC)	DRIVER (POWER)³	
<b>UNV</b> - 120/277V <b>347</b> - 347V	<b>FDND</b> - Factory Non-Dimming <b>FD00</b> - Factory 0-10V 0.1% Dim <b>FD01</b> - Factory 0-10V 1% Dim <b>FD10</b> - Factory 0-10V 10% Dim <b>FDDA</b> - Factory DALI 0.1% Dim <b>FDDX</b> - Factory DMX Dim <b>FDTR</b> - Factory TRIAC Dim <b>LD01</b> - Lutron Hi-Lume 1% Dim <b>X_</b> - Specify Driver	Footnotes: ¹ Contact factory about custom beam options. ³ Standard driver box is included

### 4) FIXTURE MOUNTING

MOUNTING	FLANGE TYPE
<b>DWC</b> - Drywall Ceiling <b>DWW</b> - Drywall Wall <b>MTK</b> - Mud-In Tray Kit (removable) <b>TC1</b> - 9/16" Flat T-Bar Type <b>TC2</b> - 9/16" Bolt & Slot T-Bar Type <b>TC1</b> - 15/16" Flat T-Bar Type	<b>F1</b> - 9/16" Flat <b>F2</b> - 9/16" Bolt-Slot

OPTIONAL	
EMERGENCY BACKUP	WIRELESS MODULE
<b>EMC</b> - Emergency Circuit <b>EMB</b> - Emergency Battery (10 W — Remote) <b>X_</b> - Specify Backup  Specify requirements at time of order.	<b>WCN</b> - Wireless Communication Node (Connected to LED Driver In-Fixture or In-Driver Box) <b>PIR</b> - Wireless Communication Node + PIR Sensor (Standard Lens for Low Bay < 10') <b>MW</b> - Wireless Communication Node + MW Sensor (Standard for Low Bay < 10') <b>X_</b> - Other – Specify Embedded Component or Specific Non-Standard Sensor Detection Range

## FIXTURE DESIGN

### Dimensions

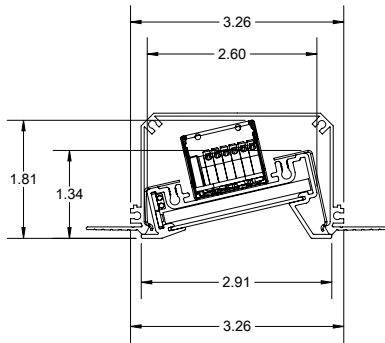

Fixture in Mud-in Tray

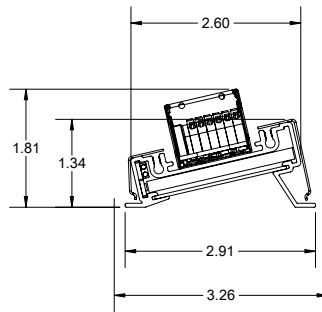

Fixture with Driver

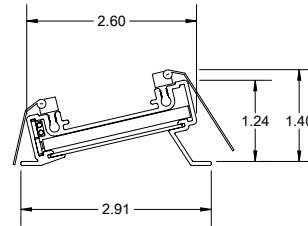

Fixture without Driver  
(remote)

### Mounting

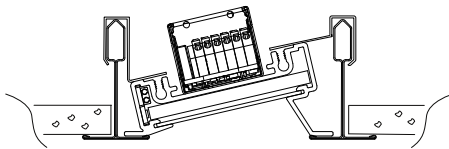

Grid Mounting

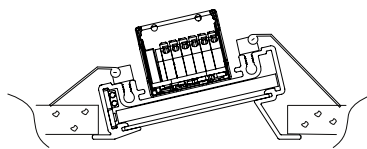

Drywall

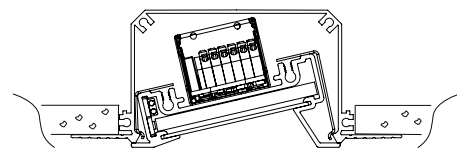

Mud-in Tray Kit

## DRYWALL CEILING MOUNTING (DC)

Choice of accent surface orientation

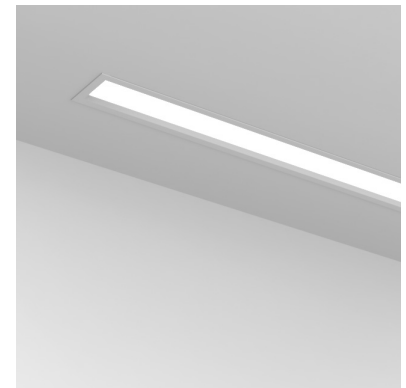
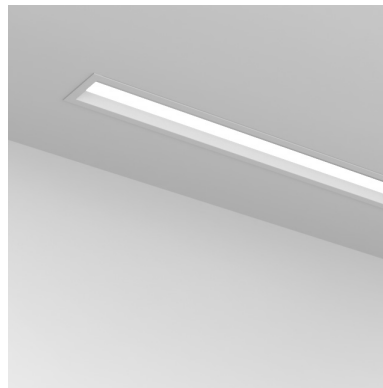

## DRYWALL WALL MOUNTING (DW)

Choice of accent surface orientation

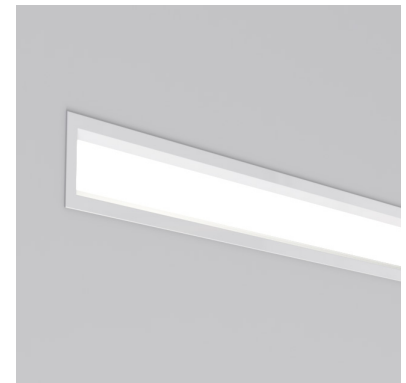

SMARTBEAM® TECHNOLOGY

The Ultimate Control of Lighting Distributions

SmartBeam makes it easy to specify the exact light required for any architectural space. Available in every XICO product; it is now possible to create truly tailored and engaging lighting that transform spaces, improves visual comfort, and saves energy.

To learn more about our SmartBeam Technology, please click or scan the QR Code.

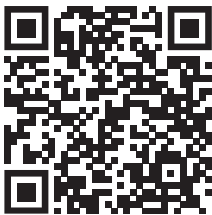

LPW Efficacy Conversion Chart

CODE	CCT SELECTED							
	2200K	2700K	3000K	3500K	4000K	5000K	5700K	6500K
80	–	0.91	0.96	1.00	1.04	1.11	1.11	1.11
90	–	0.91	0.96	1.00	1.04	1.11	1.11	1.11
95	–	0.91	0.96	1.00	1.04	1.11	1.03	1.04
SUN	–	0.90	0.92	1.00	1.01	1.07	1.04	1.05

LPW Performance

	DIRECT	
	DLAM	DA5545
LM/W	110	109

DIRECT PHOTOMETRICS

48" Length, 80+/3500K CRI/CCT, 3,000 Lumens

Static White Light

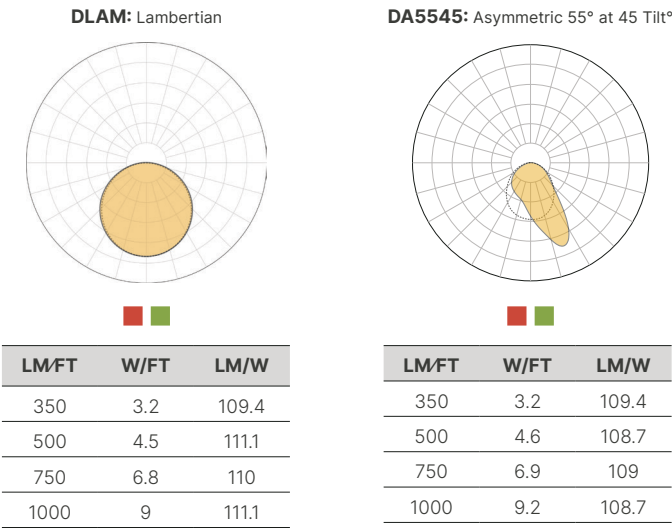

LED OPTIONS

80: Standard 80+ CRI

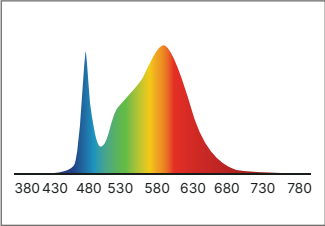

90: Standard 90+ CRI

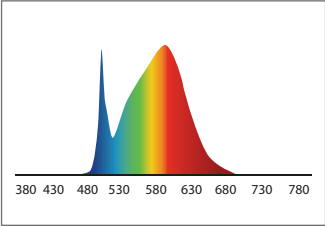

95: High-Definition 95+ CRI

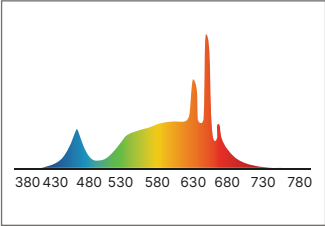

SUN: Full Spectrum "SunLike"

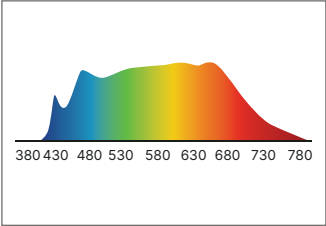

CODE	DESCRIPTION	TYPICAL LED DATA							
		CCT	CRI	CRI R9	TM30 Rf	TM30 Rg	CQS	M/P Ratio	LPW
80	Standard 80 CRI	3500K	82.5	7.8	84	96.7	82.5	0.51	190
90	Standard 90 CRI	3500K	91	54.3	89.3	98.9	89.2	0.55	175
95	High Definition 95 CRI	3500K	97.1	95	–	–	–	0.70	163
SUN	Full Spectrum SunLike®	3500K	95	85	–	–	–	–	130

## POWER & CONTROLS

### Voltage

#### Fixture Voltage (AC)

120–277 VAC

347 VAC, 50/60 Hz

#### Power Location

Integral

#### LED Driver

Factory Selected, 36–39V Constant Current

### Drivers

**FDND** - Factory Non-Dimming  
**FD00** - Factory 0-10V 0.1% Dim  
**FD01** - Factory 0-10V 1% Dim  
**FD10** - Factory 0-10V 10% Dim  
**FDDA** - Factory DALI 0.1% Dim  
**FDDX** - Factory DMX Dim  
**FDTR** - Factory TRIAC Dim  
**LD01** - Lutron Hi-Lume 1% Dim  
**X\_** - Specify Driver

### Emergency Backup (Optional)

**EMC** - Emergency Circuit  
**EMB** - Emergency Battery  
 (10 W — Remote)  
**X\_** - Specify Backup

#### Power

10 W

#### Illumination Time

90 minutes

#### IP Rating

Suitable for Dry and Damp Locations,  
 indoor use only

### XBox

#### Remote Driver Boxes (Optional)

To create a clean and organized power solution for multiple fixture installations see our Xbox Specification Guide. Reach out to a XICO Sales Representative to discuss your project's needs.

### Compatible Control Options



## Page 8 of 8